

Buer Road Nos. 2-30 (even)

Burlington Road Nos. 1-25(odd), Nos. 41-89 (odd), Nos. 1-4 (consec.) Jubilee Terrace

Burlington Gardens Nos. 1-18 (consec.)

Elysium Street Nos. 1-30 (consec.), and Bearcroft House

Fulham High Street No. 47A All Saints Primary School

Fulham Park Gardens Nos. 3-41 and 45-84 (consec.)

Fulham Park Road Nos. 2-12 (consec), Eridge House

Landridge Road No.1, No. 3, Nos. 2-26 (even), and Rose Villa, and The Coach House,

New Kings Road No. 130, No. 132, Nos. 136-184 (even)

Rigault Road Nos. 1-37 (odd), Nos. 2-44 (even), No. 58, No. 60 and Burlington Lodge

Planning permission is required for the painting of external unpainted brickwork and the repainting of painted brickwork to the front elevation of the above properties.

Please note that these planning controls are in addition to those which apply everywhere. If you need advice as to what development does or does not need planning permission you should contact the Environment Department reception at the address on page 1.

Architrave A strip or moulding used to cover the joint between a frame and a wall, as round a door or window frame; the lowest of the three sections of an entablature in classical architecture.

Baluster A pillar or column supporting a handrail or coping, a series forming a balustrade.

Barge board A board fixed to the projecting end of a roof over a gable, usually in pairs, one to each slope.

Bays Compartments into which the nave or roof of a building is divided. The term is also used for projecting windows.

Bow window Similar to a bay window but curved in plan.

Bracket A projecting support. In brickwork or masonry it could be called a Corbel.

Building line The main mass of a building as defined by its facades.

Canopy A roof-like projection over a door or window; a hood.

Capital The head or crowning feature of a column.

Cill/Sill A slab of stone or wood at the base of a window or door opening giving protection to the wall beneath.

Colonnade A series of columns.

Console An ornamental bracket.

Corbel A projection from a wall, often in brick, iron, wood or stone, which provides support for a beam or roof truss. Sometimes decorated.

Curtilage The total land area attached to a dwelling house.

Dentils A row of small rectangular blocks forming part of the bed mould of a cornice

Dormer A window in a sloping roof, usually that of a sleeping-apartment, hence the name.

Eaves The lower part of a roof projecting beyond the face of the wall.

Entablature The upper part of an Order of architecture, comprising architrave, frieze and cornice, supported by a colonnade.

Facade The face or elevation of a building.

Fascia The wide board over a shop front.

Finial The upper portion of a pinnacle, bench end or other architectural feature.

Gable The triangular portion of a wall, between the enclosing lines of a sloping roof. In Classic architecture it is called a pediment.

Glazing bar A thin rebated wood bar which divides a large window into smaller lights.

Hipped Gable A roof which is hipped at the upper part of its end but has a part gable below the hip.

Hipped Roof A roof which is sloped at its ends as well as on the sides.

Ionic The Ionic order is lighter, more elegant, than the Doric, with slim columns, generally fluted. It is principally distinguished by the volutes of its capitals.

Light One window as bounded by the mullions and transoms and sometimes itself divided into several panes.

Lintel The beam spanning the opening of a window or doorway. It may be wood, concrete, stone or steel.

Mansard roof A roof with steep lower slope and flatter upper portion, named after Mansart. Also known as 'gambrel' roof.

Order An Order in architecture comprises a column, with base (usually), shaft, and capital, the whole supporting an entablature. The Greeks recognised three Orders: Doric, Ionic and Corinthian. The Romans added the Tuscan and the Composite (later known as Roman), while using the Greek Orders in modified form.

Pantile A shaped clay tile with a double curve across its width from concave on one side to convex on the other so that it overlaps the tile adjoining it on the side.

Parapet The portion of wall above the roof gutter, sometimes battlemented; also applied to the same feature, rising breast high, in balconies, platforms and bridges.

Party wall A wall separating two adjoining buildings and common to them.

Pediment In Classic architecture, a triangular piece of wall above the entablature, enclosed by raking cornices. In Renaissance architecture used for any roof end, whether triangular, broken or semicircular. In Gothic such features are known as gables.

Pilaster A rectangular feature in the shape of a pillar, but projecting only about one-sixth of its breadth from a wall, and the same design as the Order with which it is used.

Porch A roofed projecting structure to give protection against the weather to an entrance.

Quoin A term generally applied to the corner-stones at the angles of a building and hence to the angle itself.

Ridge tile A tile for covering the ridge of a roof: commonly of half-round or angular section.

Rustication A method of forming stonework with roughened surfaces and recessed joints, principally employed in Renaissance buildings.

Sash The sliding light of a sash window.

Semi-basement A storey set halfway below ground level below the ground floor storey of a property.

Stock brick The most commonly used in the district at any given time.

Storey The part of a building between each floor level and the floor above it.

String course A decorative or slightly projecting horizontal band of brickwork or stone in the external face of a wall.

Stucco A fine quality of plaster, much used in Roman and Renaissance architecture for ornamental modelled work in low relief. In England, it was extensively employed in the late 18th and early 19th century as an economical medium for the modelling of external features, in lieu of stone.

Terracotta Clay material moulded and burnt and used for features such as cornices, vases etc. Can be used with or without a glazed finish.

Voussoirs The wedge-shaped stones or bricks of an arch.

Volute The scroll or spiral occurring in Ionic, Corinthian and Composite capitals.

Sketch showing good practice and inappropriate alterations to a property within the conservation area

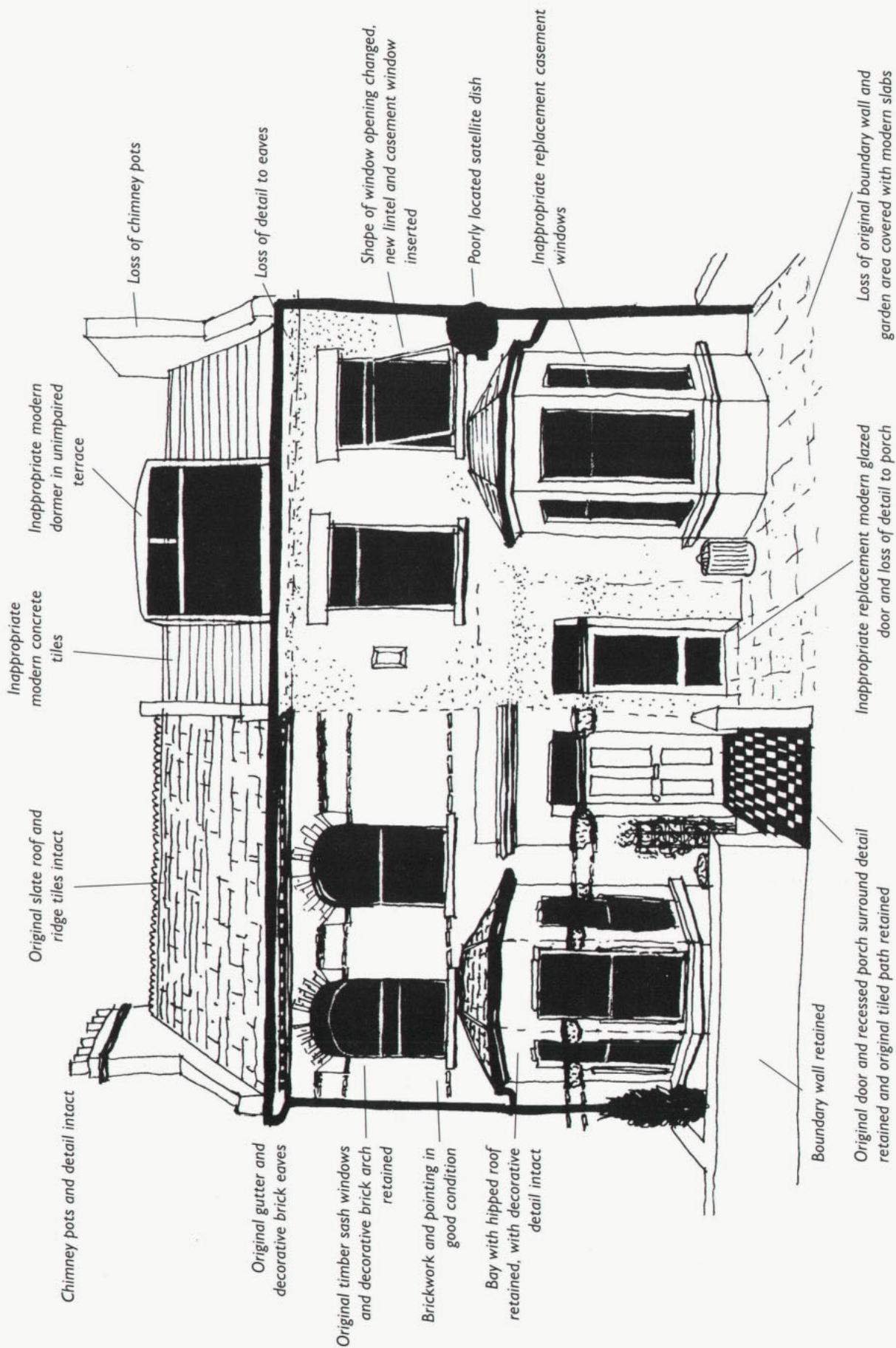



Fulham Pottery circa 1876

Hammersmith and Fulham Archives and Local History Centre



Design and Conservation
Development Services Division
Environment Department
London Borough of Hammersmith & Fulham
Town Hall, King Street, LONDON W6 9JU

August 2001



INVESTOR IN PEOPLE