

EXTENSION TO BROOK GREEN CONSERVATION AREA WITH EFFECT FROM 13 NOVEMBER 2018

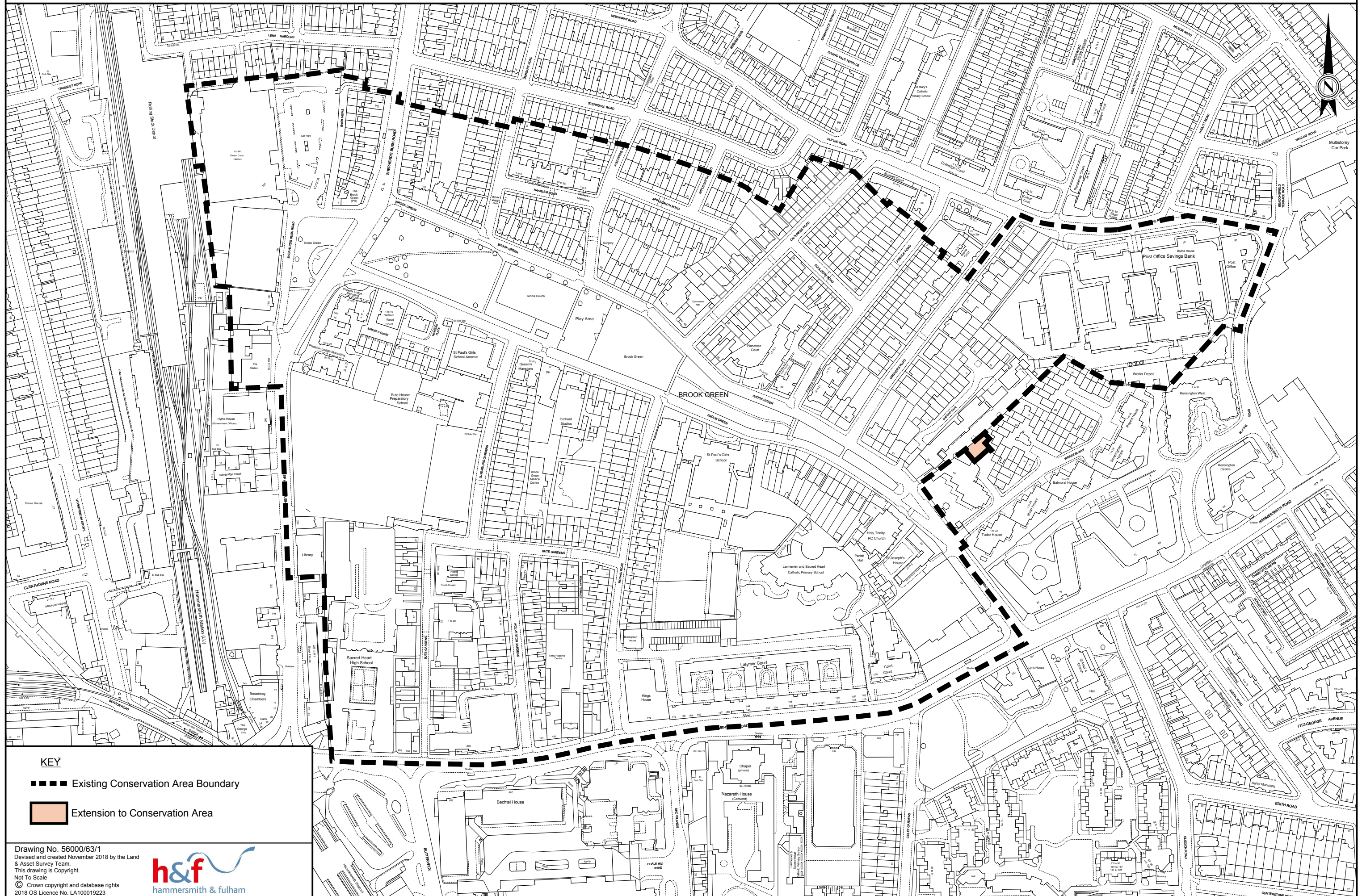

EXTENSION TO CRABTREE CONSERVATION AREA WITH EFFECT FROM 13 NOVEMBER 2018

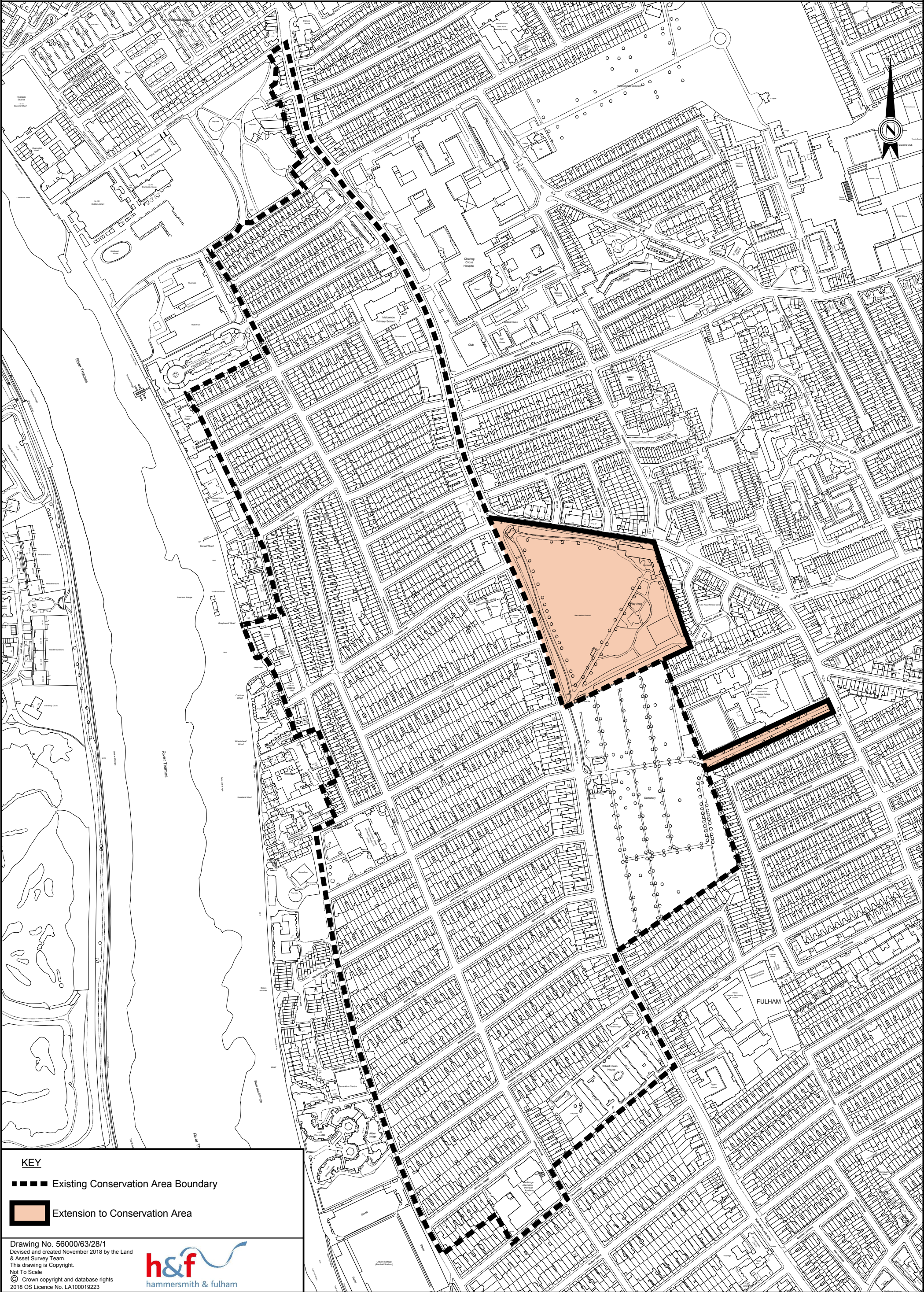

EXTENSION TO FULHAM REACH CONSERVATION AREA WITH EFFECT FROM 13 NOVEMBER 2018

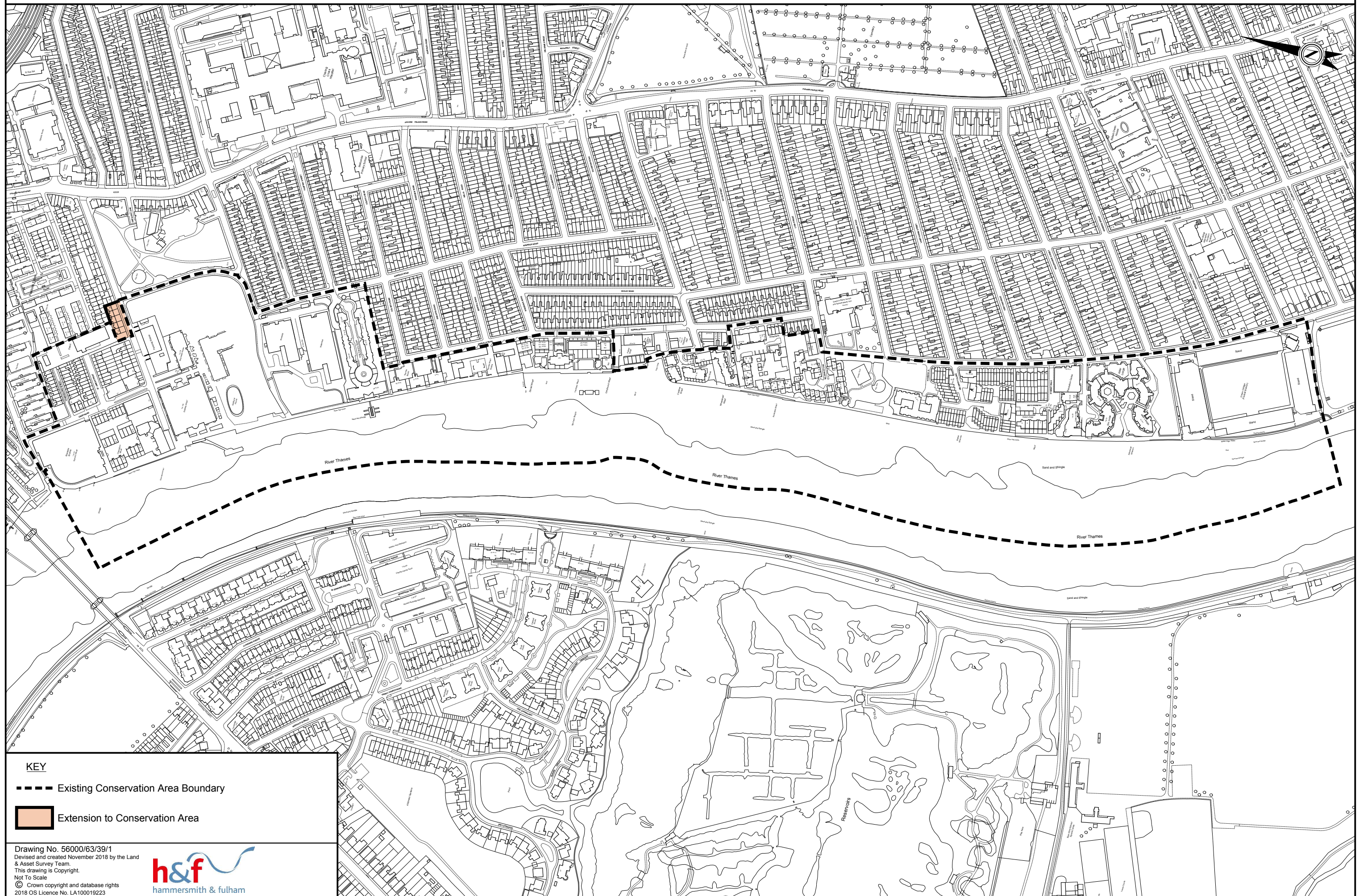

BOUNDARY AMENDMENTS TO HAMMERSMITH TOWN HALL CONSERVATION AREA WITH EFFECT FROM 13 NOVEMBER 2018



EXTENSION TO HURLINGHAM CONSERVATION AREA WITH EFFECT FROM 13 NOVEMBER 2018



KEY

--- Existing Conservation Area Boundary

 Extension to Conservation Area

Drawing No. 56000/63/4/1
Devised and created November 2018 by the Land
& Asset Survey Team.
This drawing is Copyright.
Not To Scale
© Crown copyright and database rights
2018 OS Licence No. LA100019223



EXTENSION TO INGERSOLL AND ARMINER CONSERVATION AREA WITH EFFECT FROM 13 NOVEMBER 2018

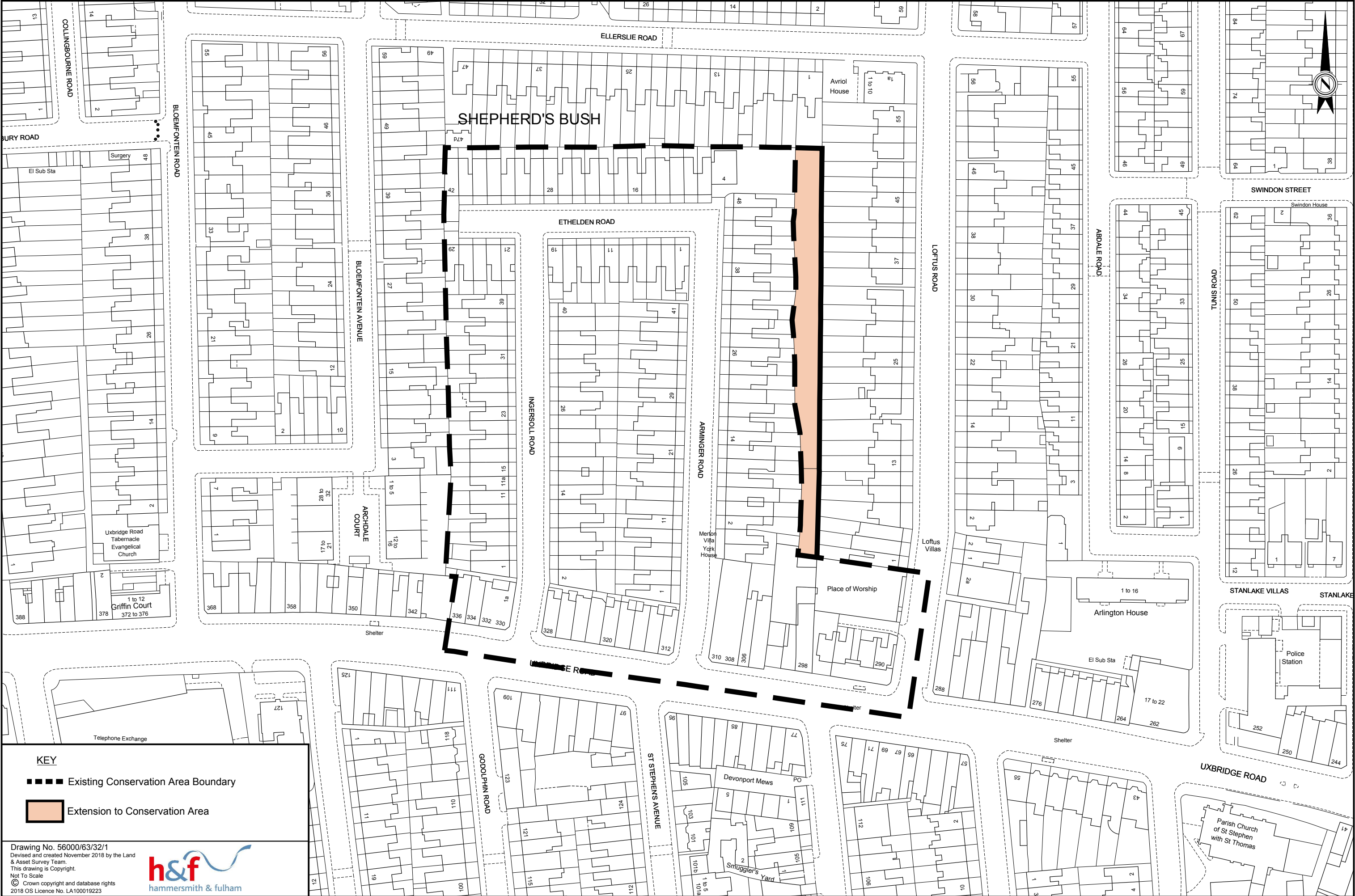

EXTENSION TO ST MARY'S CONSERVATION AREA WITH EFFECT FROM 13 NOVEMBER 2018



KEY

--- Existing Conservation Area Boundary

Extension to Conservation Area

Drawing No. 56000/63/24/1
Devised and created November 2018 by the Land
& Asset Survey Team.
This drawing is Copyright.
Not To Scale
© Crown copyright and database rights
2018 OS Licence No. LA100019223

h&f
hammersmith & fulham

EXTENSION TO STUDDRIDGE STREET CONSERVATION AREA WITH EFFECT FROM 13 NOVEMBER 2018

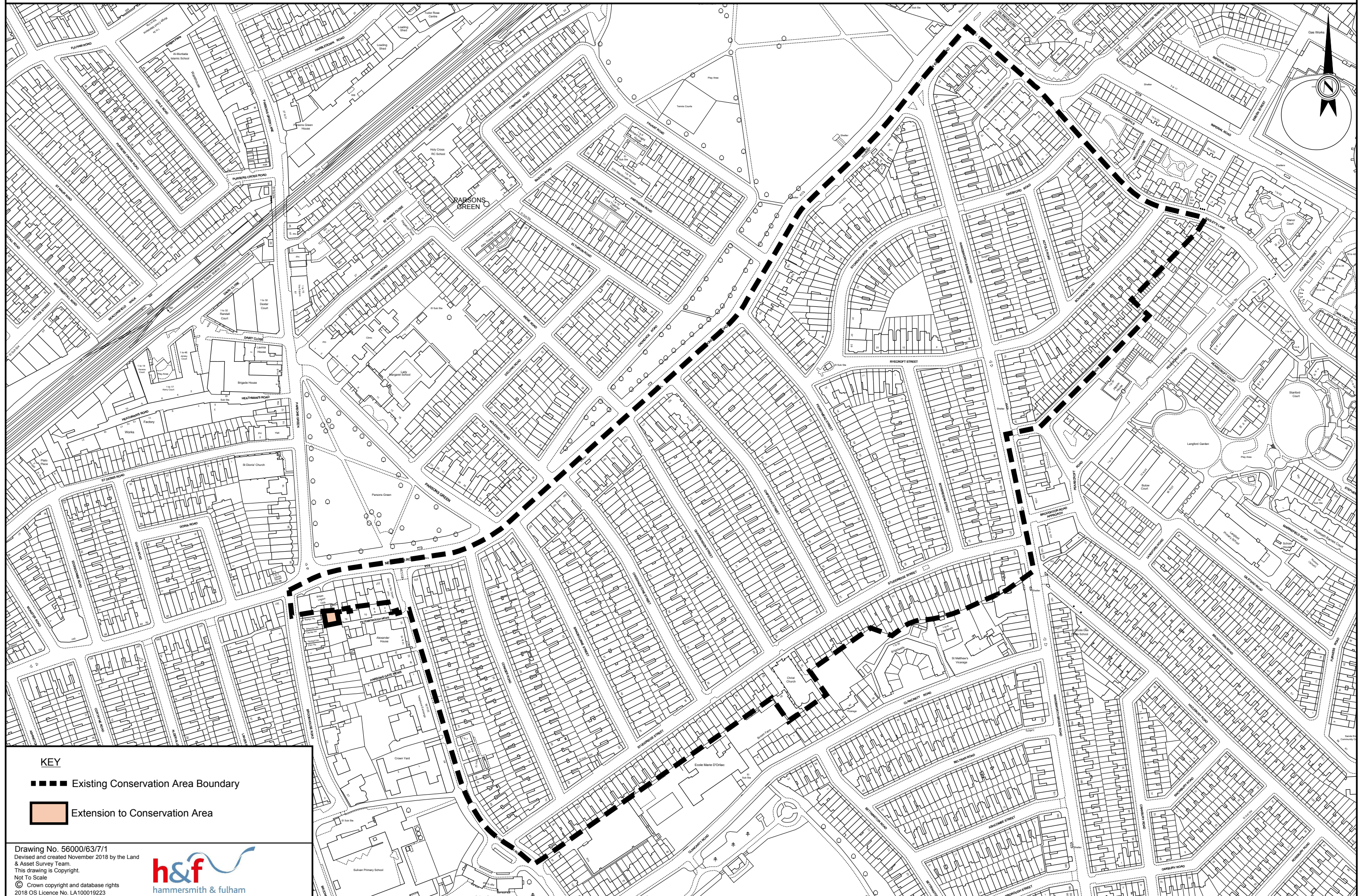

KEY

Existing Conservation Area Boundary

Extension to Conservation Area

Drawing No. 56000/63/7/1
Devised and created November 2018 by the Land
& Asset Survey Team.
This drawing is Copyright.
Not To Scale
© Crown copyright and database rights
2018 OS Licence No. LA100019223

h&f
hammersmith & fulham

BOUNDARY AMENDMENTS TO WALHAM GREEN CONSERVATION AREA INCLUDING TRANSFER OF PROPERTIES FROM MOORE PARK AND WALHAM GROVE CONSERVATION AREAS TO WALHAM GREEN CONSERVATION AREA WITH EFFECT FROM 13 NOVEMBER 2018

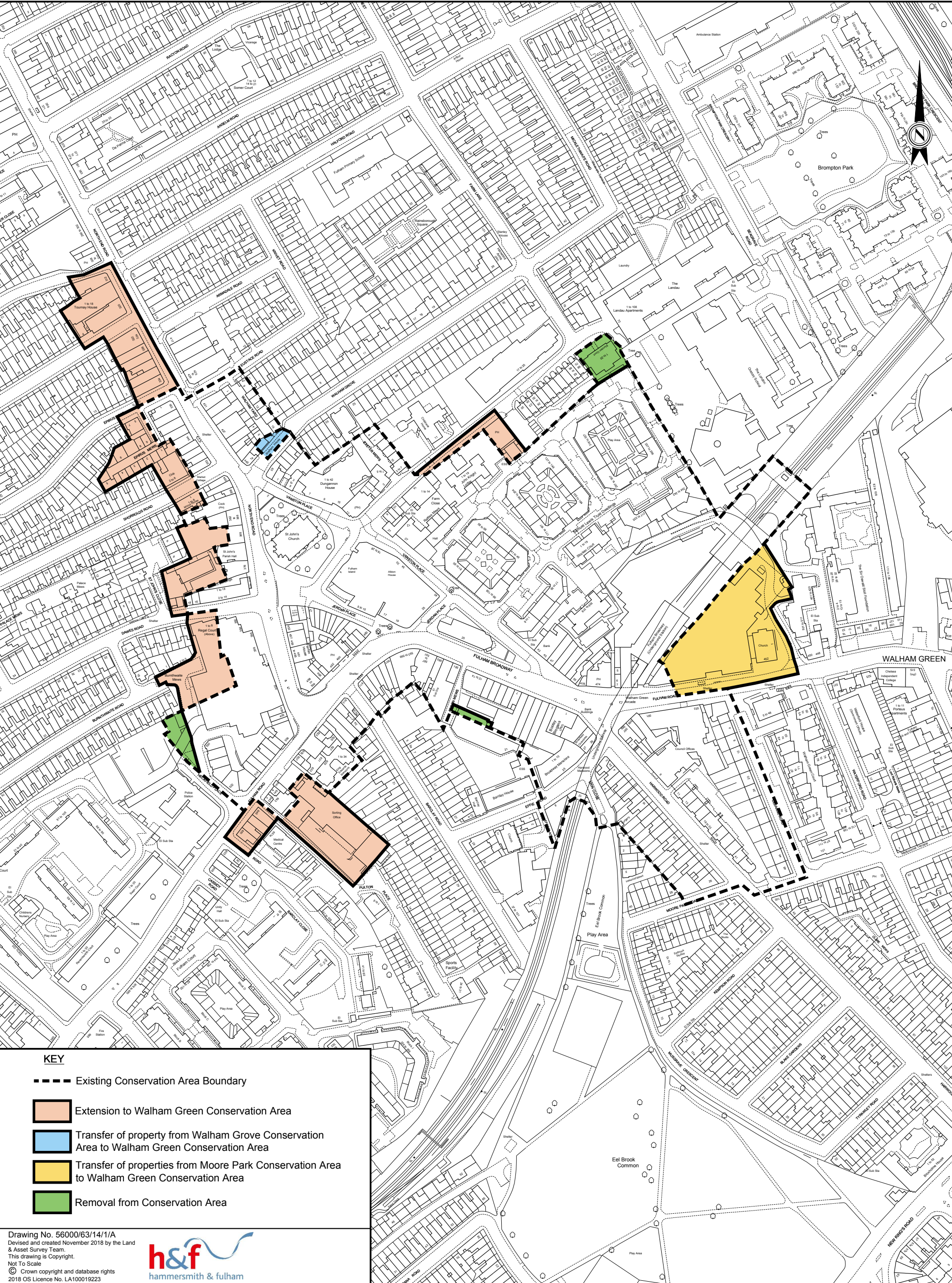

KEY

- Existing Conservation Area Boundary
- Orange box: Extension to Walham Green Conservation Area
- Blue box: Transfer of property from Walham Grove Conservation Area to Walham Green Conservation Area
- Yellow box: Transfer of properties from Moore Park Conservation Area to Walham Green Conservation Area
- Green box: Removal from Conservation Area

Drawing No. 56000/63/14/1/A
Devised and created November 2018 by the Land & Asset Survey Team.
This drawing is Copyright.
Not To Scale
© Crown copyright and database rights
2018 OS Licence No. LA100019223

h&f
hammersmith & fulham